

Maps

- Map 1: Number of New Residential Unit Permits in Genesee County (2001)
- Map 2: Number of New Residential Unit Permits in Livingston County (2001)
- Map 3: Number of New Residential Unit Permits in Monroe County (2001)
- Map 4: Number of New Residential Unit Permits in Ontario County (2001)
- Map 5: Number of New Residential Unit Permits in Orleans County (2001)
- Map 6: Number of New Residential Unit Permits in Seneca County (2001)
- Map 7: Number of New Residential Unit Permits in Wayne County (2001)
- Map 8: Number of New Residential Unit Permits in Wyoming County (2001)
- Map 9: Number of New Residential Unit Permits in Yates County (2001)
- Map 10: Number of New Residential Unit Permits in the G/FL Region (2001)
- Map 11: Number of New Industrial Building Permits in the G/FL Region (2001)
- Map 12: Number of New Commercial Building Permits in the G/FL Region (2001)
- Map 13: Number of New Community Service Building Permits in the G/FL Region (2001)
- Map 14: Number of New Residential Unit Permits in the TMA (2001)
- Map 15: Number of New Industrial Building Permits in the TMA (2001)
- Map 16: Number of New Commercial Building Permits in the TMA (2001)
- Map 17: Number of New Community Service Building Permits in the TMA (2001)

Number of New Residential Unit Permits in Genesee County (2001)

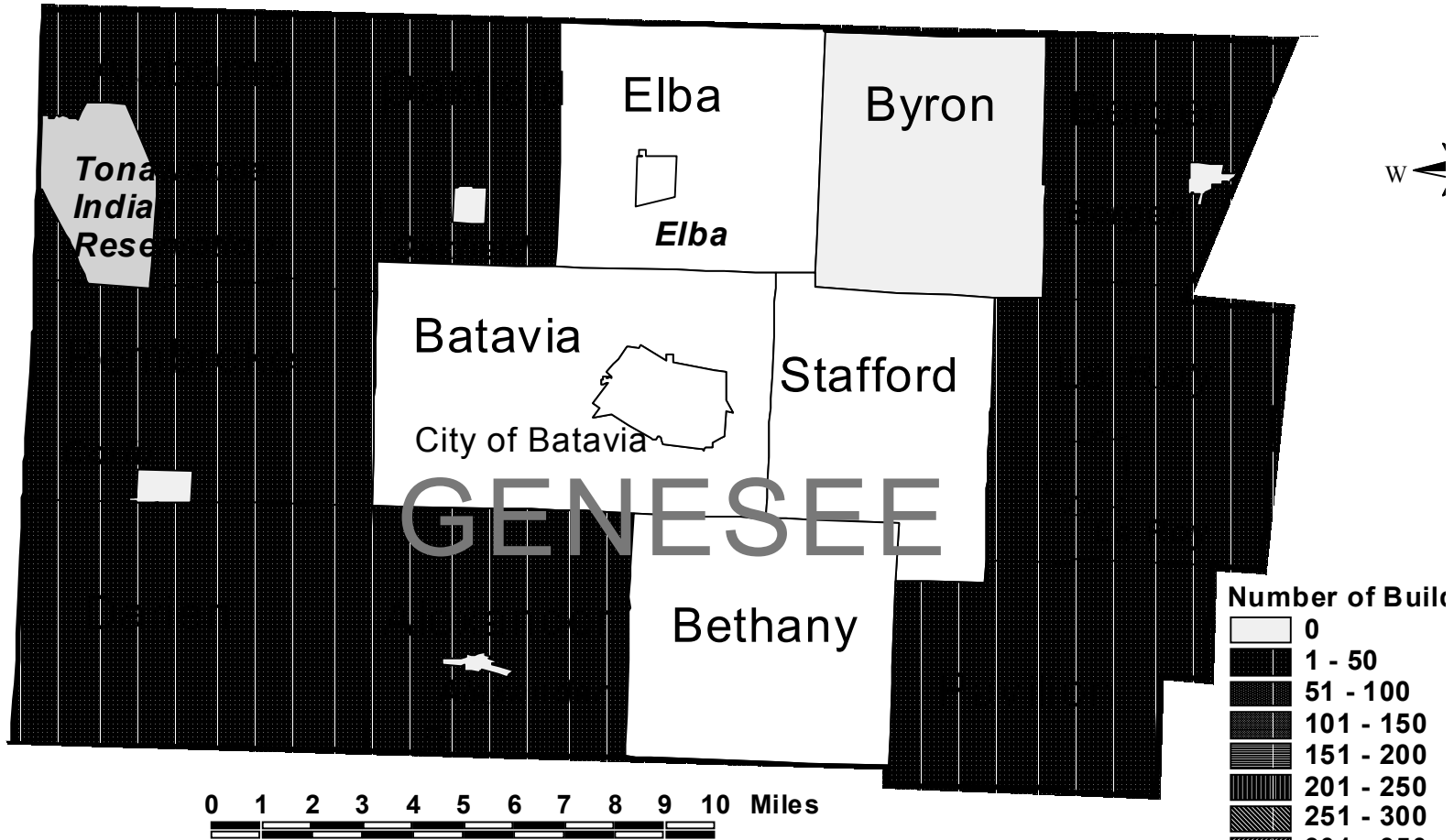

Map 1

Source: Municipal Representatives (2002),
 Base Map: NYS DOT (February 1996),
 Prepared by Genesee/ Finger Lakes Regional Planning Council (March 2002).

Number of New Residential Unit Permits in Livingston County (2001)

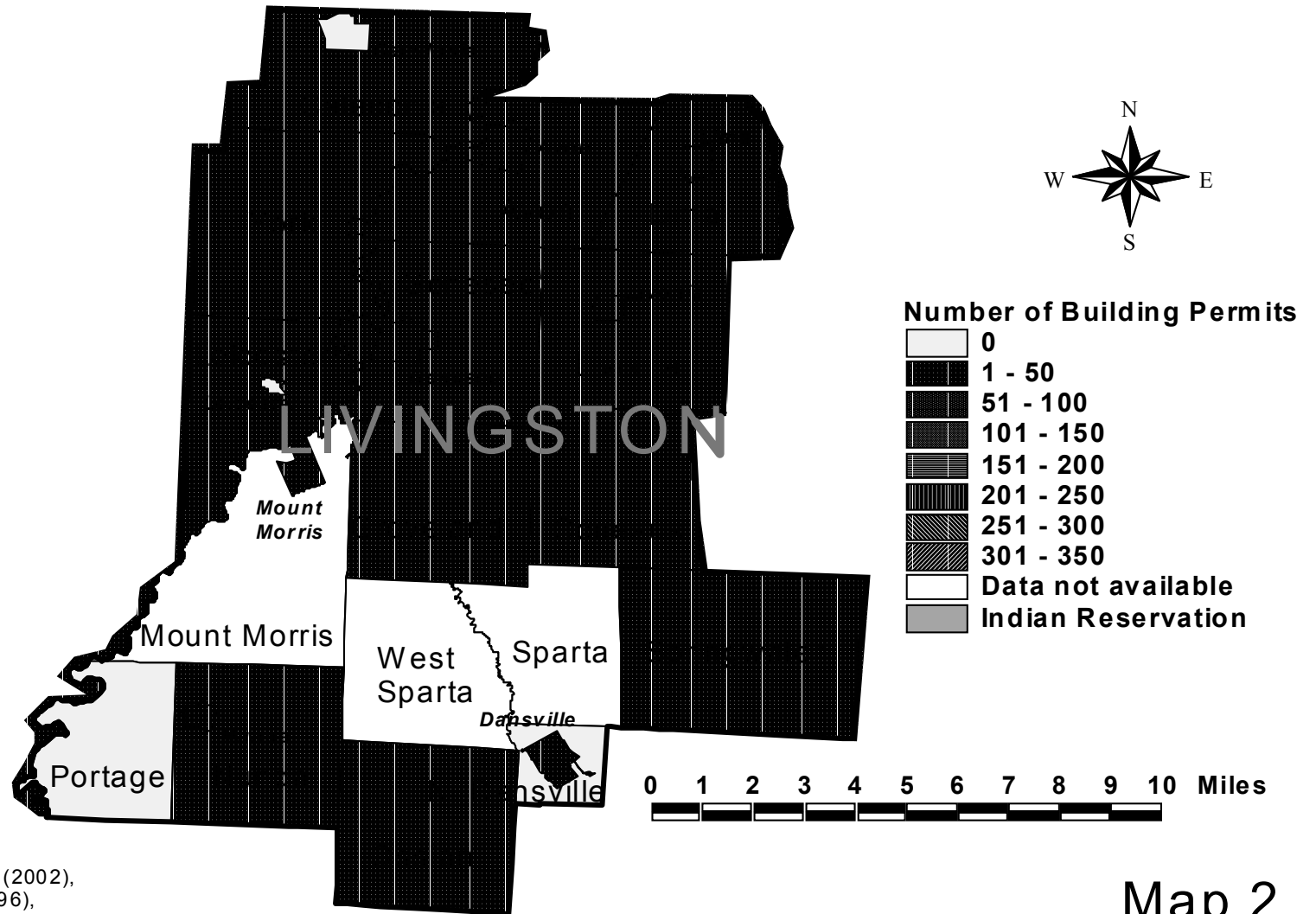

Source: Municipal Representatives (2002),
Base Map: NYS DOT (February 1996),
Prepared by Genesee/ Finger Lakes Regional Planning Council (March 2002).

Map 2

Number of New

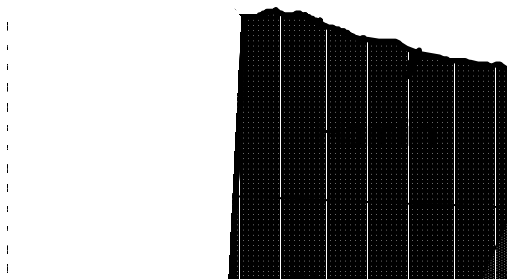

Number of New

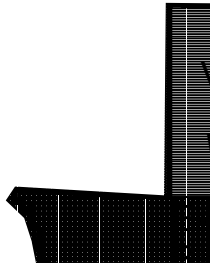

Number of New |

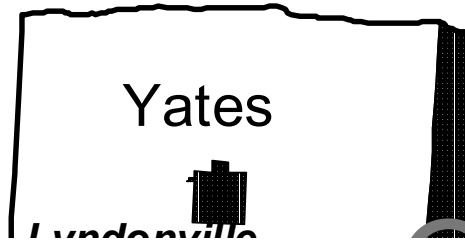

Number of New Residential Unit Permits in Seneca Co

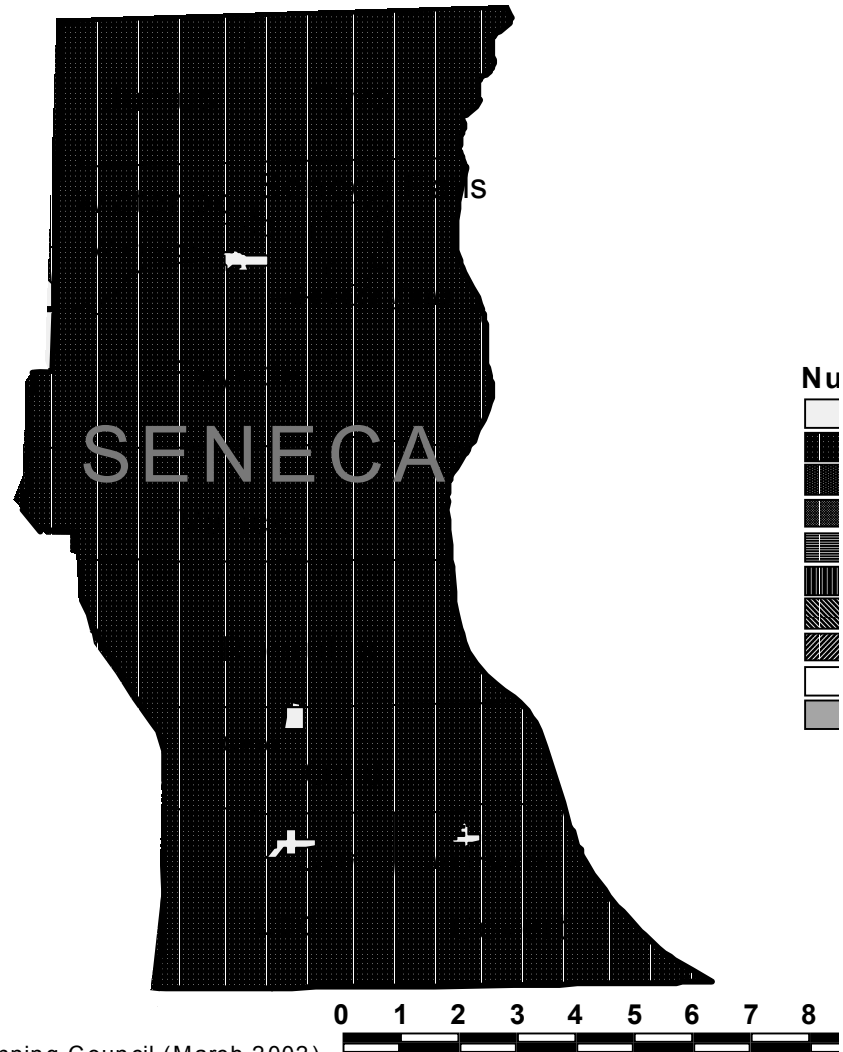

Source: Municipal Representatives (2002),
Base Map: NYS DOT (February 1996),
Prepared by Genesee/ Finger Lakes Regional Planning Council (March 2002).

Number of New Residential Unit Permits in Wayne County (2001)

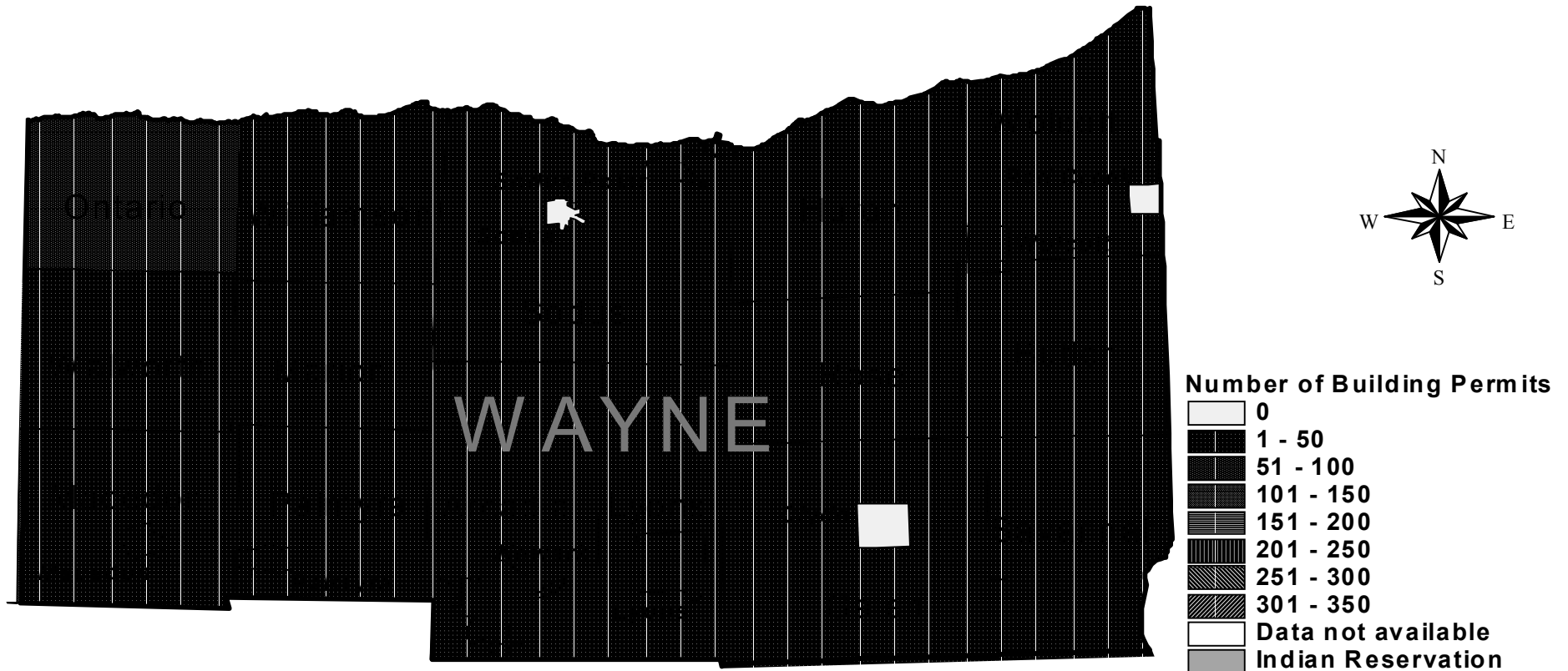

Source: Municipal Representatives (2002),
Base Map: NYS DOT (February 1996),
Prepared by Genesee/ Finger Lakes Regional Planning Council (March 2002).

0 1 2 3 4 5 6 7 8 9 10 Miles

Map 7

Number of New Residential Unit Permits in Wyoming



Source: Municipal Representatives (2002),
Base Map: NYS DOT (February 1996),
Prepared by Genesee/ Finger Lakes Regional Planning Council (March 2002).



Number of New Residential Unit Permits in Yates County (2001)

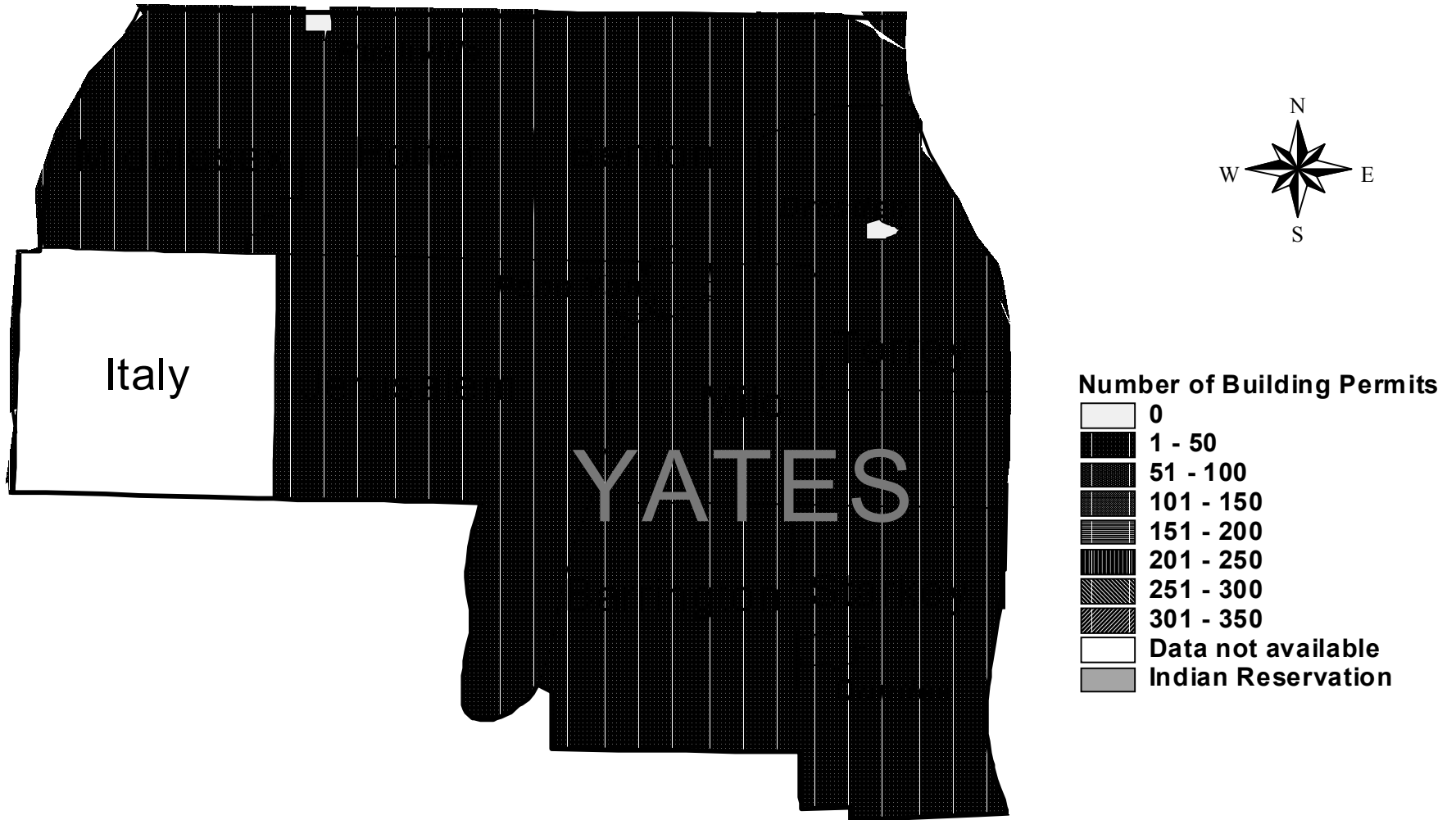

Source: Municipal Representatives (2002),
Base Map: NYS DOT (February 1996),
Prepared by Genesee/ Finger Lakes Regional Planning Council (March 2002).

0 1 2 3 4 5 6 7 8 9 10 Miles

Map 9

Number of New Residential Unit Permits in the Genesee/ Finger Lakes Region (2001)

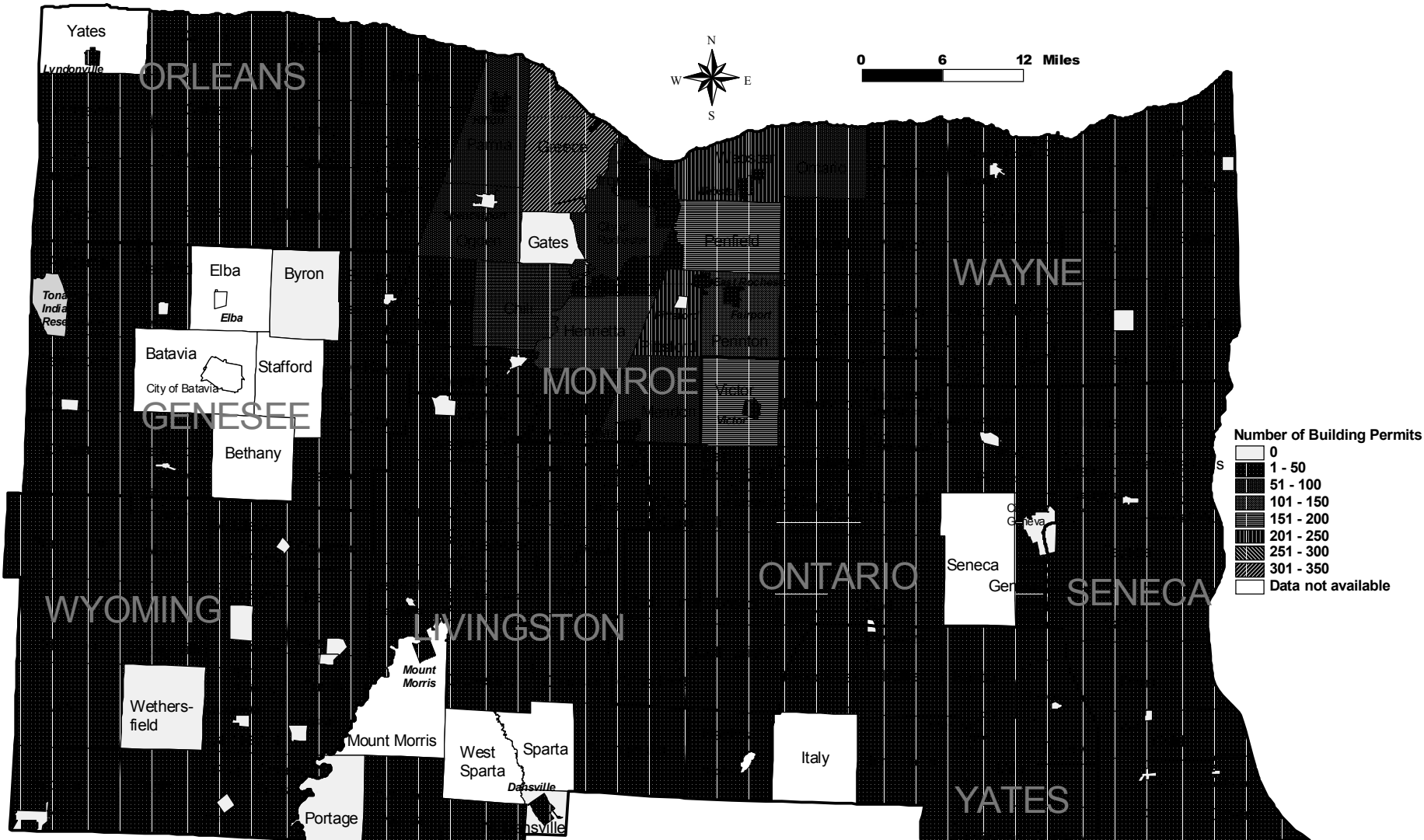

Source: Municipal Representatives (2002),
 Seneca County Code Enforcement (2002),
 Wyoming County Building Department (2002).
 Base Map: NYS DOT (February 1996),
 Prepared by Genesee/ Finger Lakes Regional Planning Council (March 2002).

Map 10

Number of New Commercial Building Permits in the Genesee/ Finger Lakes Region (2001)

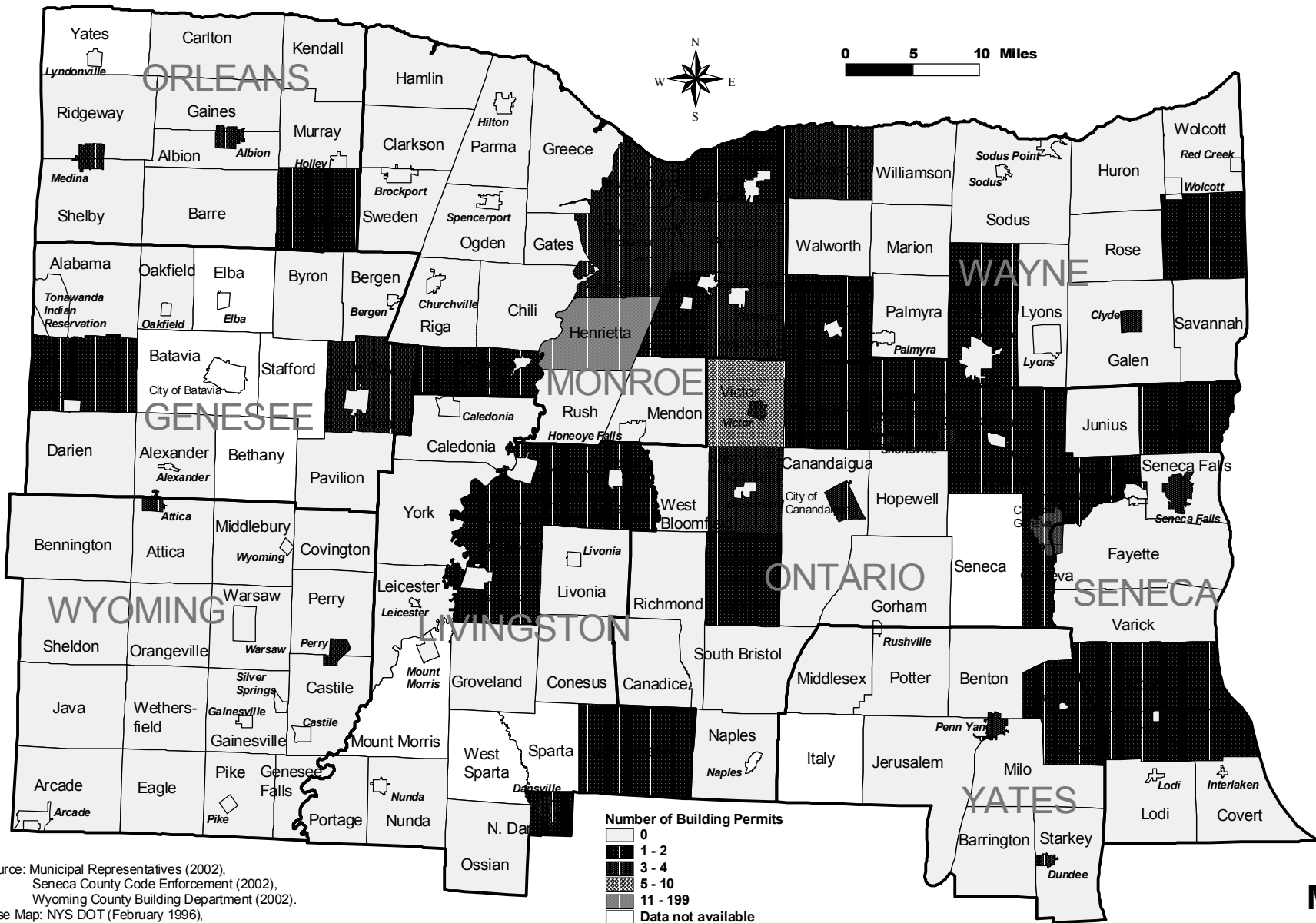

Source: Municipal Representatives (2002),
 Seneca County Code Enforcement (2002),
 Wyoming County Building Department (2002).
 Base Map: NYS DOT (February 1996).
 Prepared by Genesee/ Finger Lakes Regional Planning Council (March 2002).

Map 12

Number of New Community Service Building Permits in the Genesee/ Finger Lakes Region (2001)

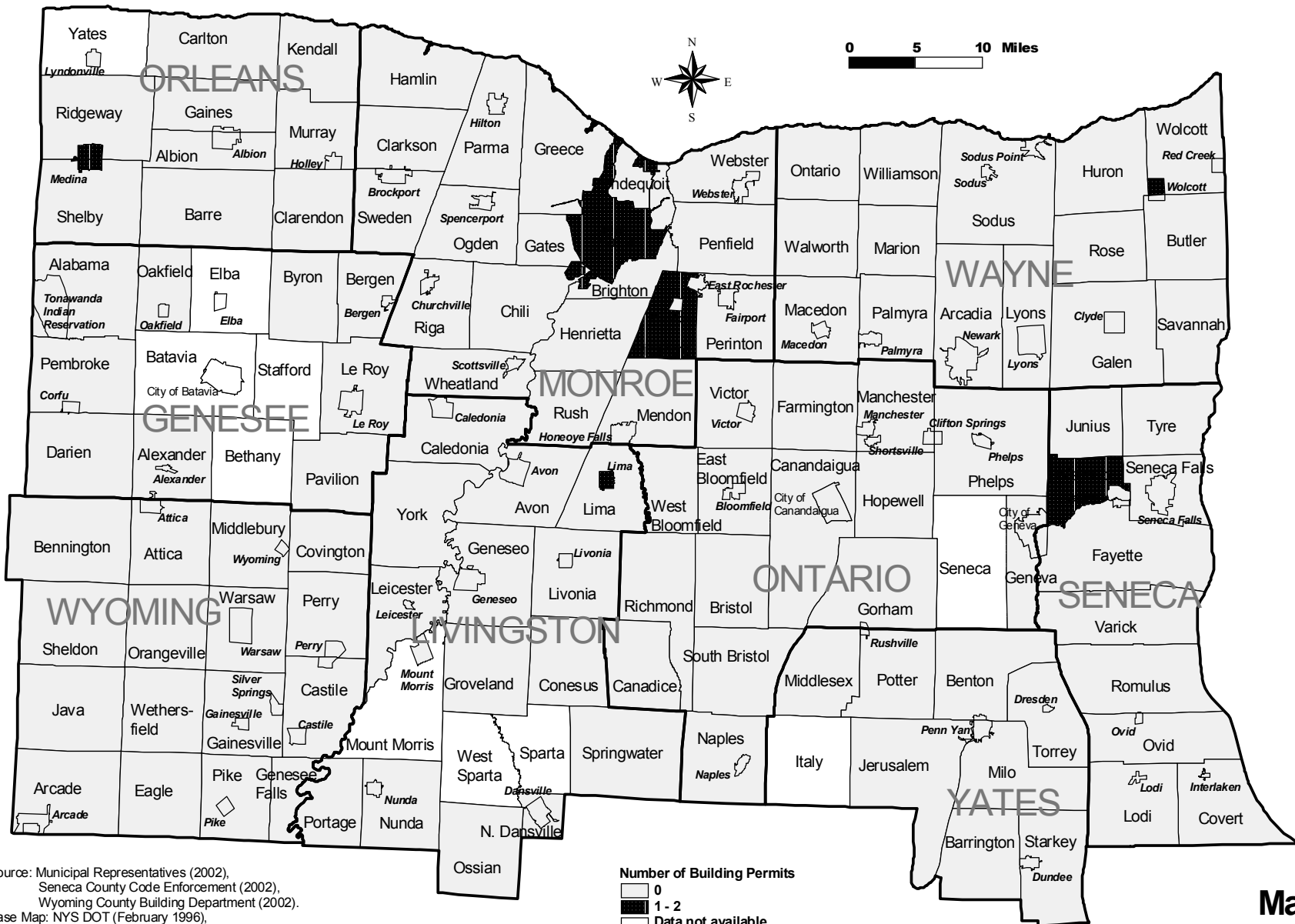

Source: Municipal Representatives (2002),
 Seneca County Code Enforcement (2002),
 Wyoming County Building Department (2002).
 Base Map: NYS DOT (February 1996).
 Prepared by Genesee/ Finger Lakes Regional Planning Council (March 2002).

Map 13

Number of New Resi Permits in the TMA (

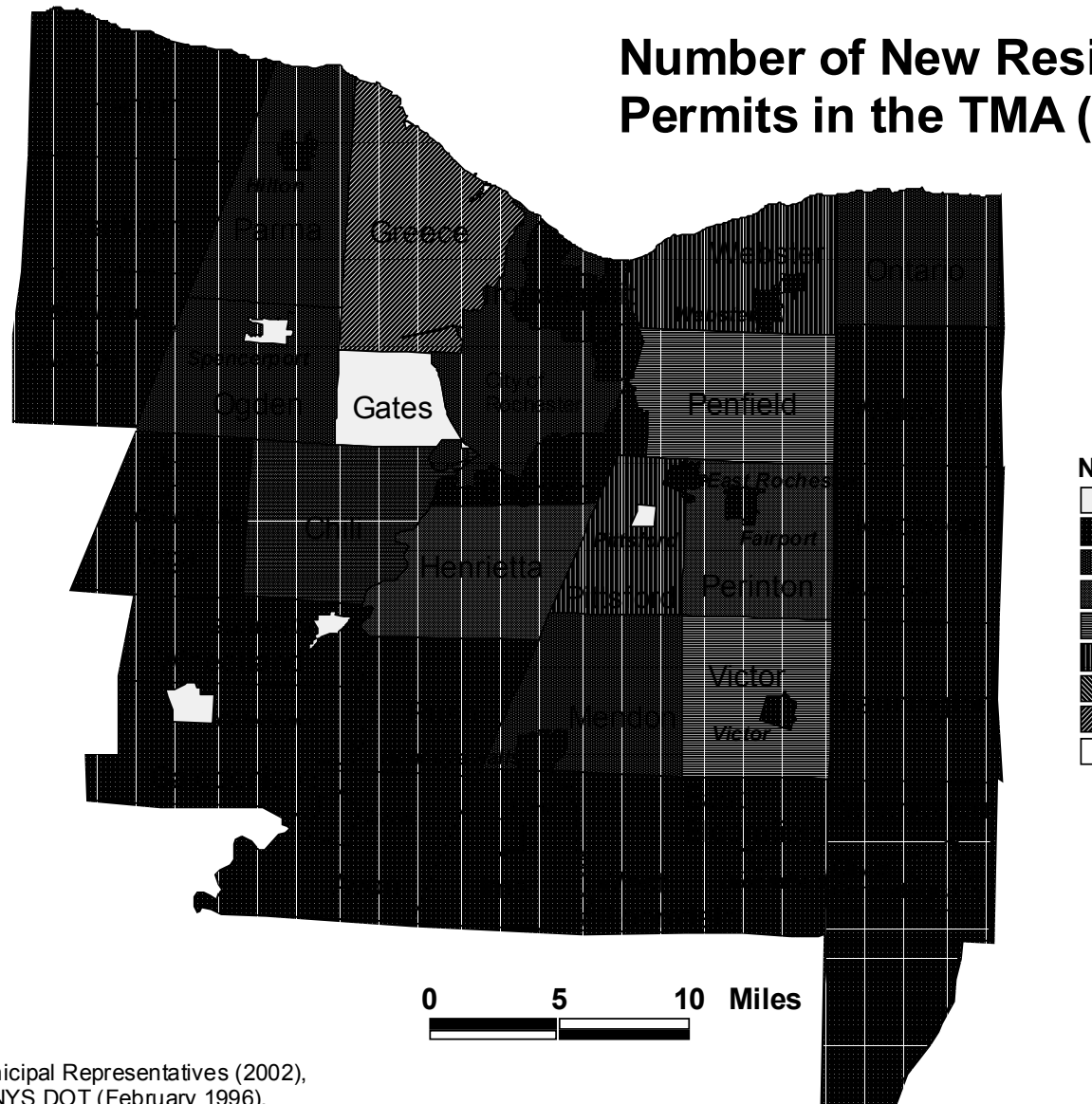

Source: Municipal Representatives (2002),
Base Map: NYS DOT (February 1996).

